

013 - Frame, Bumper and Fascia 405 - Body Hold Down

Dealer Comments:

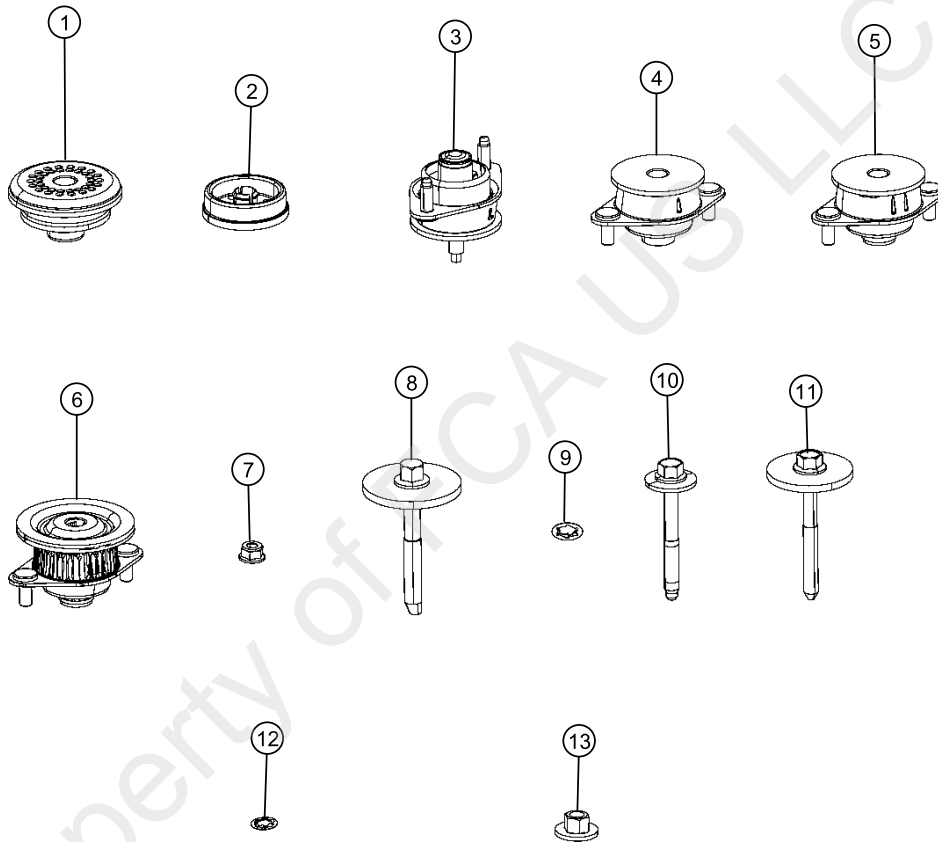

013 - Frame, Bumper and Fascia 405 - Body Hold Down

Pos	Description	Part Number	Qty	Eng	Trans	Line
1	CUSHION, Body Hold Down, A-Pillar, Right or Left	68236167AA	2			J U
2	CUSHION, Body Hold Down, A-Pillar, Right or Left	68302330AA	2			J U
3	CUSHION, Body Hold Down, FESM					
3	CUSHION, Body Hold Down, FESM, Right	68236170AA	1			J U
3	CUSHION, Body Hold Down, FESM, Left	68302129AA	1			J U
4	INSULATOR, Body Hold Down					
4	INSULATOR, Body Hold Down, Right or Left, B-Pillar	68276106AA	2			J U
4	INSULATOR, Body Hold Down, Right or Left, C-Pillar	68276106AA	2			J U
5	CUSHION, Body Hold Down, C-Pillar, Right or Left	68236168AA	2			J U
6	CUSHION, Body Hold Down, D-Pillar, Right or Left	68236166AA	2			J U
7	NUT, Hex Flange Lock, M10x1.50					
7	NUT, Hex Flange Lock, M10x1.50, Body Isolator To Body	06104717AA	4			J U
7	NUT, Hex Flange Lock, M10x1.50, Body Isolator To Frame	06104717AA	12			J U
7	NUT, Hex Flange Lock, M10x1.50, Body Isolator To Frame	06104717AA	8			J U
8	SCREW, Hex Head, M14X2X106.60, Body Isolator To Frame	06509458AA	2			J U
9	SPRING RETAINER, Push On Round With Teeth, For M14 Stud, Body Isolator To Frame	06101782	2			J U
10	SCREW, Hex Flange Head Lock, M12X1.75X107.50, Body Isolator Hold Down	06511826AA	2			J U
11	SCREW AND WASHER, Hex Flange Head, M12X1.75X116.50, Body Isolator Hold Down	06508326AA	2			J U
12	RETAINER, For M12 Stud					
12	RETAINER, For M12 Stud, Body Isolator Thru Bolt	68203633AA	6			J U
12	RETAINER, For M12 Stud, Body Isolator Thru Bolt	68203633AA	4			J U

Pos	Description	Part Number	Qty	Eng	Trans	Line
13	NUT AND WASHER, Hex, M12x1.75, Body Isolator Hold Down	06100056	2			J U

Property of FCA US LLC