

REVISIONS				
P.	LTN.	DESCRIPTION	DATE	OWN APVD
A		RELEASED PER ECO-17-014611	05OCT2017	KP RS
A1		REVISED PER ECO-19-013644	06SEP2019	JMS RY

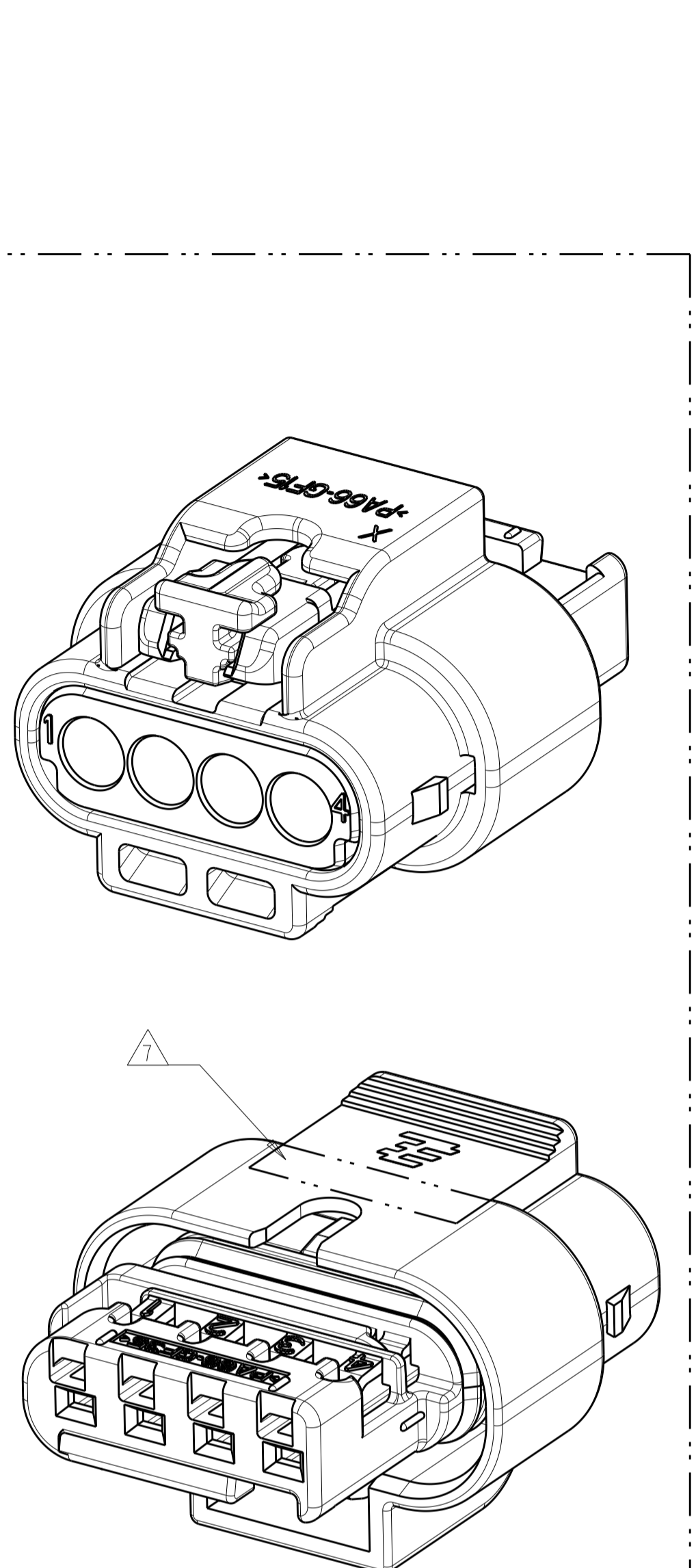

ISOMETRIC VIEWS

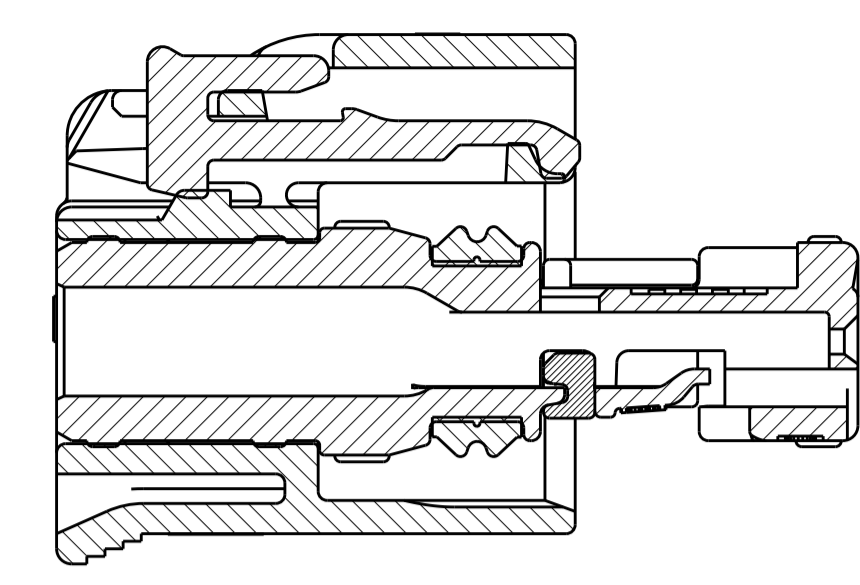
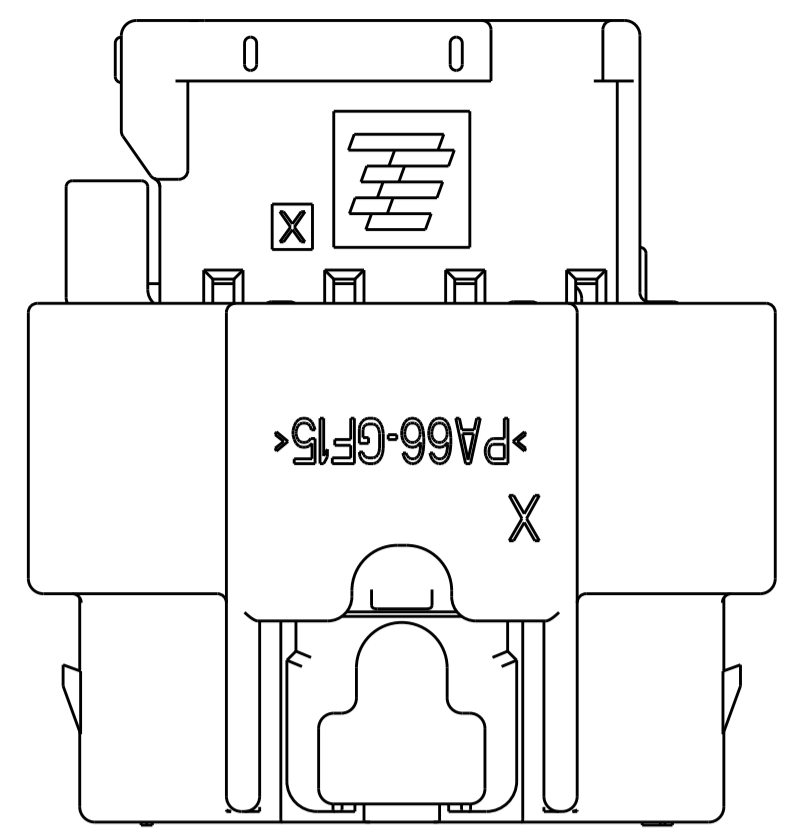

SECTION B-B SHOWN WITH CPA (WHEN APPLICABLE) IN ITS LATCHED POSITION FOR REFERENCE ONLY

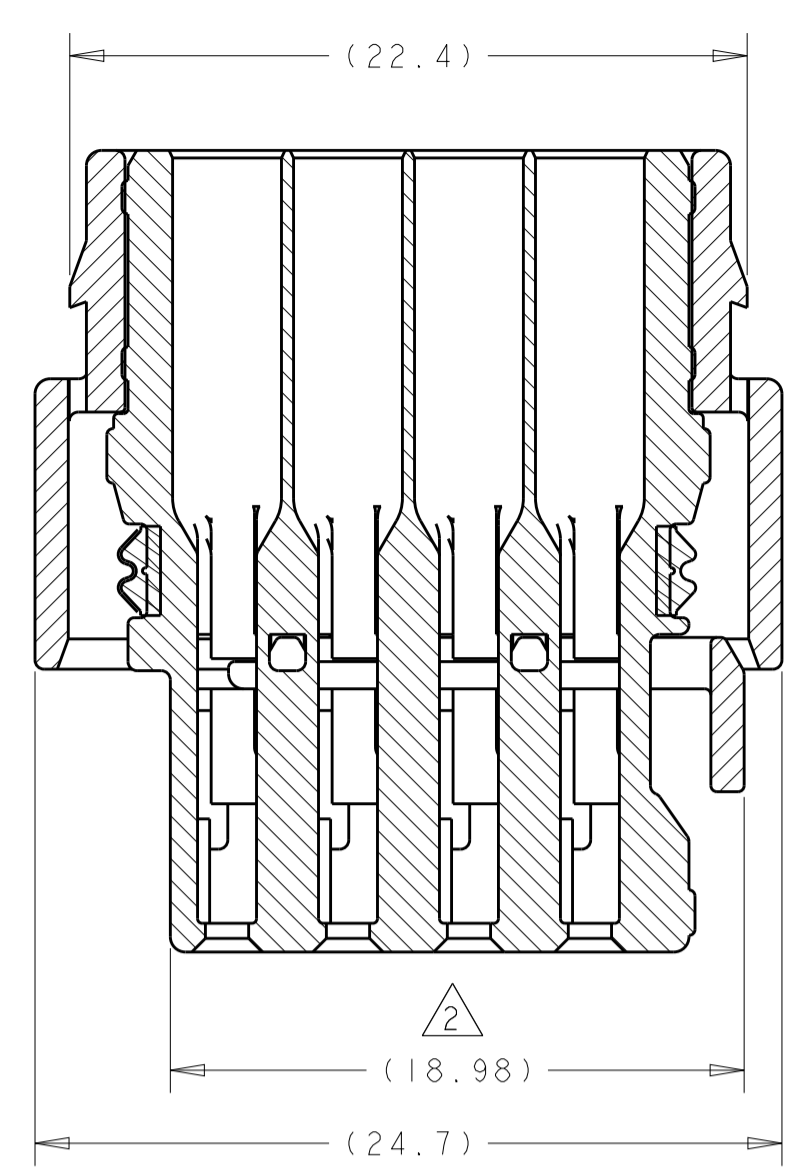

SECTION A-A

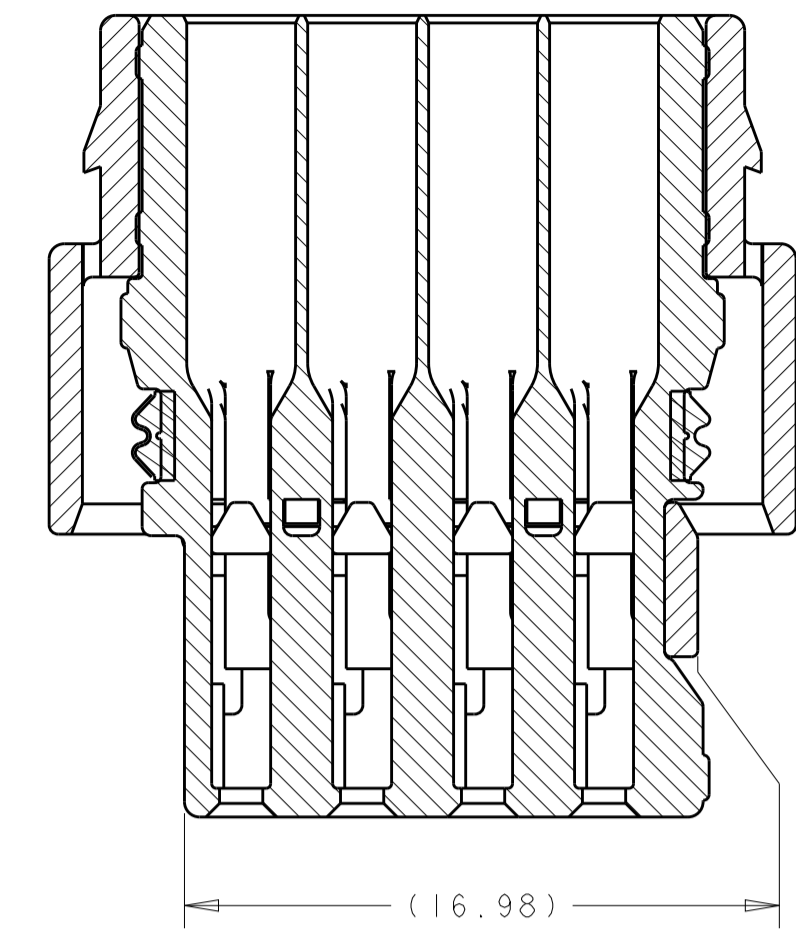

SECTION A-A SHOWN WITH TPA IN ITS LATCHED POSITION FOR REFERENCE ONLY

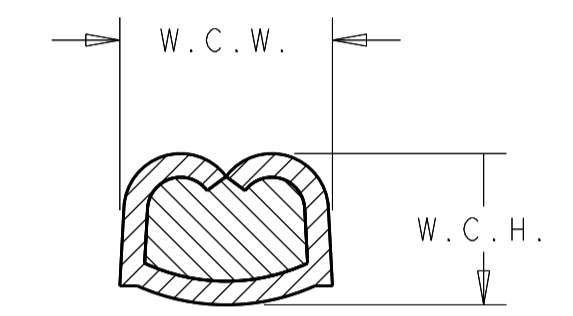
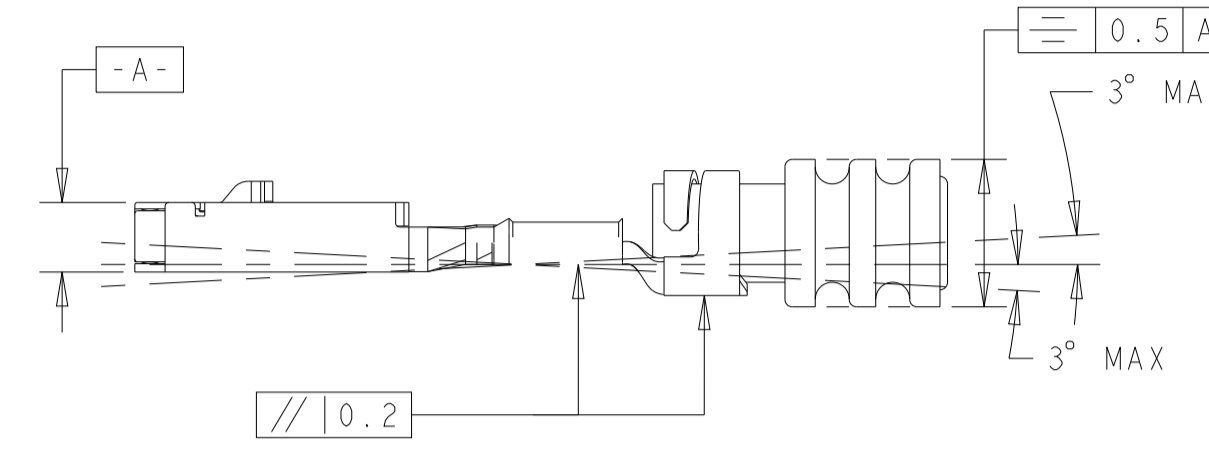
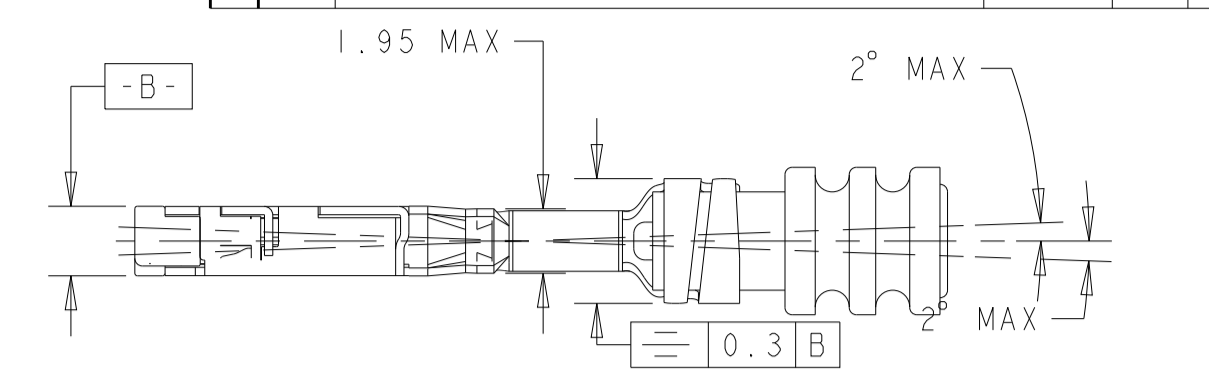

WIRE CRIMP DIMENSIONS

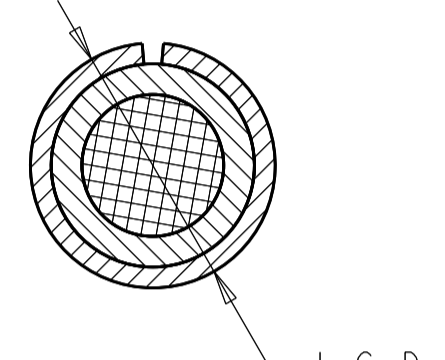

INSULATION CRIMP DIMENSIONS

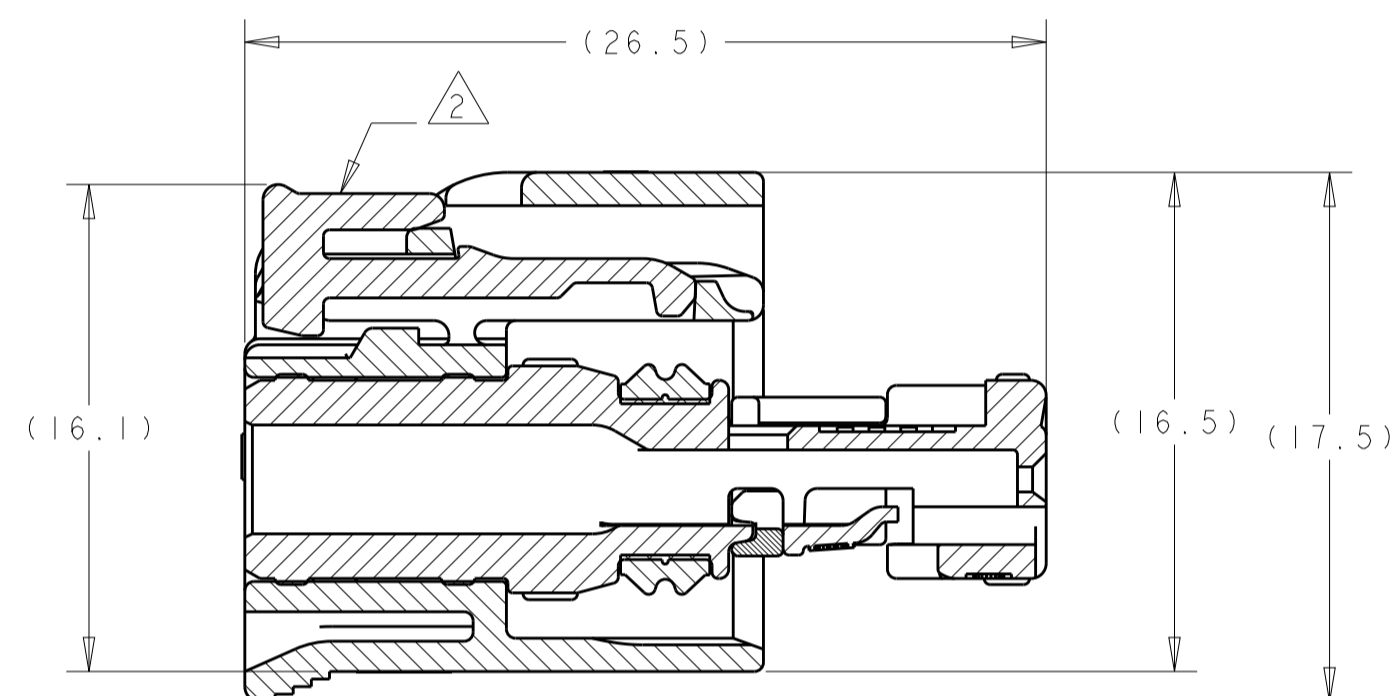

SECTION B-B

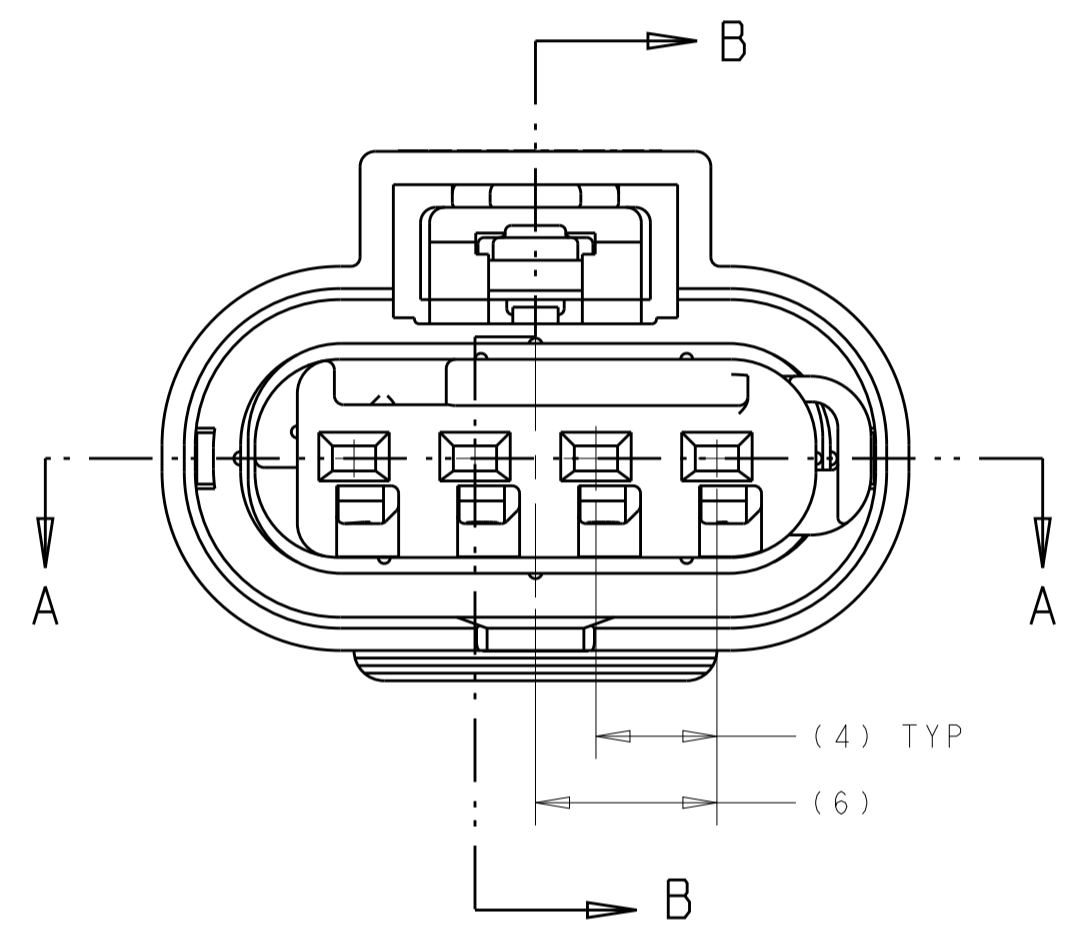

KEYING CONFIGURATIONS

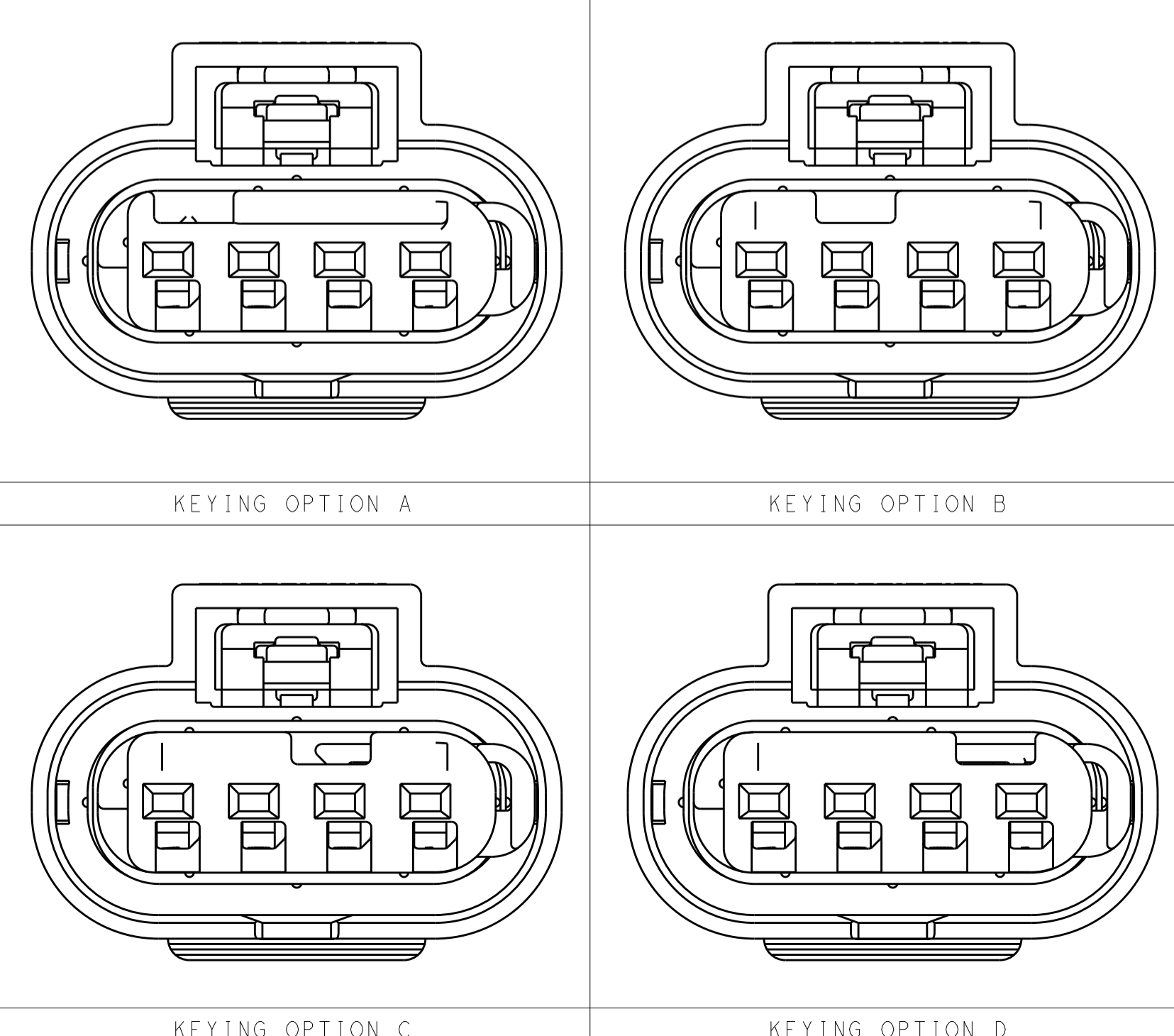

- PART NUMBER 1-2309436-1 SHOWN ON DRAWING.
- TPA AND CPA (WHEN APPLICABLE) ARE SHIPPED IN THEIR PRE-LATCHED POSITIONS. SEE INSTRUCTION SHEET 408-8968 FOR DIRECTIONS ON MOVING THE CPA AND TPA TO THE PRE-LATCHED POSITION, IF NECESSARY.
- TERMINALS SOLD SEPARATELY. FOR USE WITH TE MCON 1.2mm CLEAN BODY CONTACT WITH WIRE SEAL. SEE TE MCON 1.2-CB (CLEAN BODY) TABLE FOR APPLICABLE PART NUMBERS.
- APPLICABLE HEADER INTERFACE DRAWING 114-18679-3 IS AVAILABLE UPON REQUEST. A COPY OF THIS DRAWING CAN BE OBTAINED FROM THE TE CONNECTIVITY PRODUCT MANAGER, VIA YOUR TE CONNECTIVITY SALES REPRESENTATIVE OR CUSTOMER SERVICE.
- MINIMUM FEED THROUGH CONDITION WITH 1.0mm CLEARANCE ALL AROUND.
- NOTE LEFT BLANK INTENTIONALLY
- TRACEABILITY CODE (YY = TWO DIGIT YEAR, JJJ = 3 DIGIT JULIAN DAY, S = 1 DIGIT SHIFT) AND TE ASSEMBLY PART NUMBER PRINTED IN THIS LOCATION AT ASSEMBLY.
- FOR OPTIONAL TERMINAL CAVITY BLOCKING, CONTACT TE SALES REPRESENTATIVE OR CUSTOMER SERVICE.
- PROTOTYPE CONFIGURATION NOT SHOWN.
- NOTE REMOVED
- TPA ENGAGE FORCE: PRESET TO FULL >= 2 N AND <= 60 N.
- TPA DISENGAGE FORCE: DISENGAGE FROM FULL TO PRESET >= 2 N AND <= 60 N.
- CPA ENGAGE FORCE: PRESET TO FULL WITHOUT CONNECTORS MATED >= 40 N.
- CPA ENGAGE FORCE: PRESET TO FULL WITH CONNECTORS MATED <30 N.
- POLARIZATION FEATURE EFFECTIVENESS: CONNECTOR MATED TURNED 180° NO MATING > 125 N. WRONG KEYING NO MATING > 125 N.
- THIS PRODUCT HAS NOT COMPLETED VALIDATION TESTING.
- SEE INSTRUCTION SHEET 408-8928.
- ICD IS DEPENDENT UPON WIRE INSULATION TYPE AND OD. MUST BE SUFFICIENT TO GRIP SEAL SO IT DOES NOT SLIDE OUT OF INSULATION CRIMP WHEN INSERTING INTO CONNECTOR CAVITY BUT NOT TEAR THE SEAL.
- REFERENCE ISOMETRIC VIEWS ON SHEET 2.
- CONNECTOR APPLICATION ENVIRONMENT IS SUBMERSION IN GEAR OIL. FOR REQUIRED MECHANICAL STABILITY AND FLUID COMPATIBILITY, INDIVIDUAL WIRE SEALS PRODUCED FROM ETHYLENE/ACRYLIC (AEM) BASE MATERIALS ARE REQUIRED PER TERMINAL P/N TABLE.
- CONNECTOR HAS ETHYLENE/ACRYLIC (AEM) SEAL INTENDED TO PERFORM IN AN OIL ENVIRONMENT. SEAL IS COATED WITH OSIXO DRY LUBRICANT FOR MATING PURPOSES.
- CONNECTOR IS A ONE TIME MATE CONNECTOR. THE INTEGRITY OF THE SEAL COATING MUST BE PROTECTED AND THUS SEAL MUST REMAIN UNTOUCHED UNTIL FINAL MATE.
- CONNECTOR AND TERMINALS ARE CONSIDERED NON-SERVICEABLE AFTER EXPOSURE TO OIL ENVIRONMENT.
- PRELIMINARY PART - NOT RELEASED FOR PRODUCTION.
- SEALING PERFORMANCE IS NOT DEFINITE. SEE NOTE 26.
- THE CONNECTOR INCLUDES AEM PERIPHERAL SEAL THAT CAN SHOW DEGRADED PERFORMANCE IN CERTAIN FLUIDS. CONNECTORS MUST BE TESTED TO APPLICATION FLUIDS AND ENVIRONMENTS BEFORE RELEASING TO APPLICATION.

MAX TEMP	FEMALE TERMINAL PN	TERMINAL PLATING	AWG	APPLICABLE WIRE FINISHED O.D.	W.C.H.	W.C.W.	I.C.D.	WIRE SEAL PART NUMBER
125C	1670146-1	TIN	20	1.40 - 1.90mm	0.84 ±0.03	1.57 ±0.05		2138898-1
125C	1418850-1	TIN	18	1.90 - 2.40mm	1.11 ±0.05	1.78 ±0.05		2138898-1
150C	1670146-2	GOLD	20	1.40 - 1.90mm	0.84 ±0.03	1.57 ±0.05		2138898-1
150C	1670146-3	SILVER	20	1.40 - 1.90mm	0.84 ±0.03	1.57 ±0.05	△8	2138898-1
150C	1418850-2	GOLD	18	1.40 - 1.90mm	1.11 ±0.05	1.78 ±0.05		2138898-1
150C	1418850-2	GOLD	16	1.40 - 1.90mm	1.31 ±0.05	1.78 ±0.05		2138898-1
150C	1418850-3	SILVER	18	1.40 - 1.90mm	1.11 ±0.05	1.78 ±0.05		2138898-1
150C	1418850-3	SILVER	16	1.40 - 1.90mm	1.31 ±0.05	1.78 ±0.05		2138898-1

STATUS	CPA	INNER HOUSING	PART NUMBER
PRELIMINARY		GRAY	D 1-2309436-4
PRELIMINARY		BLUE	C 1-2309436-3
RELEASED	1488787-1	NATURAL	B 1-2309436-2
RELEASED		BLACK	A 1-2309436-1
PRELIMINARY		GRAY	D 2309436-4
PRELIMINARY	N/A	BLUE	C 2309436-3
PRELIMINARY		NATURAL	B 2309436-2
PRELIMINARY		BLACK	A 2309436-1
		COLOR KEY	
		INNER HOUSING	

THIS DRAWING IS A CONTROLLED DOCUMENT. OWN: KUMAR 01DEC2016, CHK: M. BRENNER 08DEC2016, APVD: M. BRENNER 09DEC2016

DIMENSIONS: mm. TOLERANCES UNLESS OTHERWISE SPECIFIED: 0 PLC ±0.3, 1 PLC ±0.10, 2 PLC ±0.15, 3 PLC ±0.2, 4 PLC ±0.25, ANGLES ±0.1°

MATERIAL: SEE TABLE. FINISH: SEE TABLE. WEIGHT: 4.3gms. CUSTOMER DRAWING: A100779C=2309436

TE Connectivity. CONNECTOR ASSEMBLY, FEMALE, 4 P SEALED, 1.2mm, STANDARD LATCH VERSION, OIL APPLICATION. SCALE: 4:1. SHEET 1 OF 2. REV A1

REVISIONS				
P.	LTN	DESCRIPTION	DATE	OWN APVD
-	-	SEE SHEET 1	-	-

ISOMETRIC VIEWS

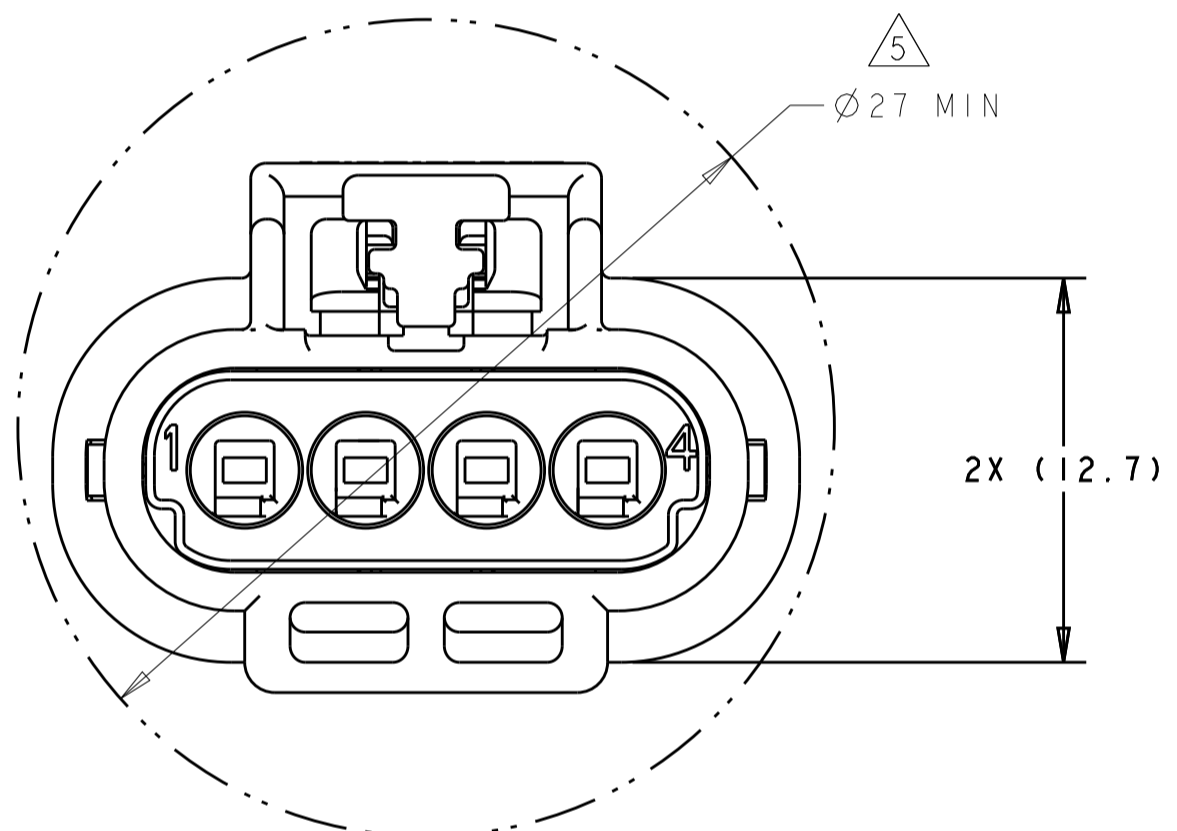

FEED THROUGH CONDITION

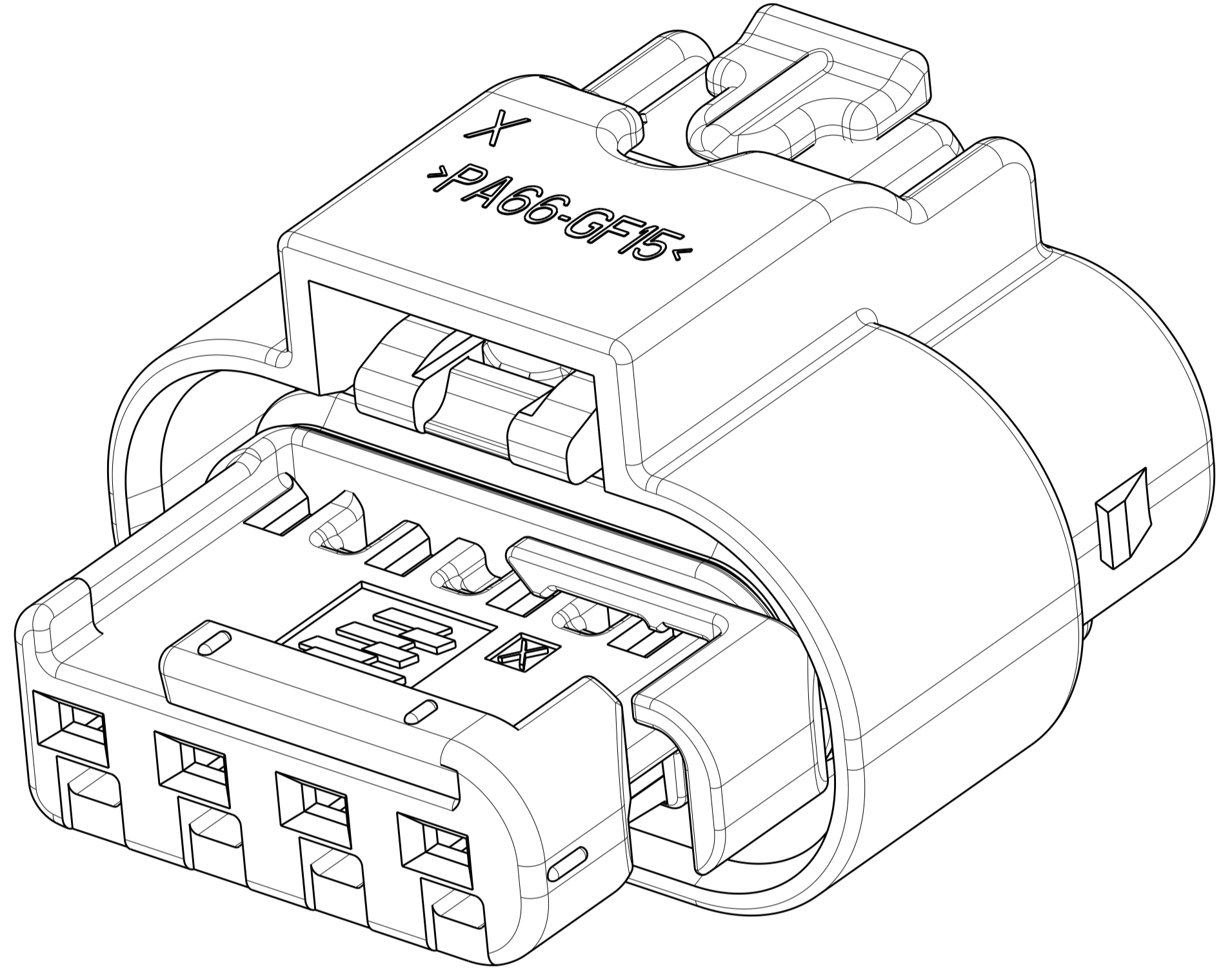

PN 1-2309436-1 SHOWN  
SCALE 8:1

THIS DRAWING IS A CONTROLLED DOCUMENT.		OWN M. KUMAR 01DEC2016																	
DIMENSIONS:		CHK M. BRENNER 08DEC2016																	
mm	TOLERANCES UNLESS OTHERWISE SPECIFIED:	APVD M. BRENNER 09DEC2016	NAME CONNECTOR ASSEMBLY, FEMALE, 4 P SEALED, 1.2mm, STANDARD LATCH VERSION, OIL APPLICATION																
<table border="1"> <tr> <td>0 PLC</td> <td>±</td> </tr> <tr> <td>1 PLC</td> <td>±0.3</td> </tr> <tr> <td>2 PLC</td> <td>±0.10</td> </tr> <tr> <td>3 PLC</td> <td>±</td> </tr> <tr> <td>4 PLC</td> <td>±</td> </tr> <tr> <td>ANGLES</td> <td>±1°</td> </tr> </table>	0 PLC	±	1 PLC	±0.3	2 PLC	±0.10	3 PLC	±	4 PLC	±	ANGLES	±1°	<table border="1"> <tr> <td>PRODUCT SPEC</td> <td>-</td> </tr> <tr> <td>APPLICATION SPEC</td> <td>-</td> </tr> </table>	PRODUCT SPEC	-	APPLICATION SPEC	-	SIZE A100779	RESTRICTED TO
0 PLC	±																		
1 PLC	±0.3																		
2 PLC	±0.10																		
3 PLC	±																		
4 PLC	±																		
ANGLES	±1°																		
PRODUCT SPEC	-																		
APPLICATION SPEC	-																		
MATERIAL SEE TABLE	FINISH -	WEIGHT 4.3gms	CAGE CODE DRAWING NO C=2309436																
CUSTOMER DRAWING		SCALE 4:1	SHEET 2 OF 2																
		REV A1																	